

HIDRA CRONO Controller

EN81-76 Programming Manual



DC81215Q00



ENGLISH

How to use the manual

Each parameter is described as follows:

XX.XX.XX - Parameter name

Parameter description (*The description may include allowable values and notes*)

EXAMPLE: *Represents a possible situation*

FACTORY DEFAULT: *Default parameters*

MIN: *Minimum value (X)*

MAX: *Maximum value (XX)*

STEP: *Increase (X)*

Access Level
(Level required to view or change the parameter)

Device
(Device required to view or change the parameter)

Connection Location
(Location to connect device)

Example

02.02.01.03 - Close door attempts

Sets the number of door close attempts before entering blocked door mode

FACTORY DEFAULT: 10

MIN: 10

MAX: 20

STEP: 1

Basic - Intermediate - Advanced - Administrator - Keypad - PC -

Controller - Car

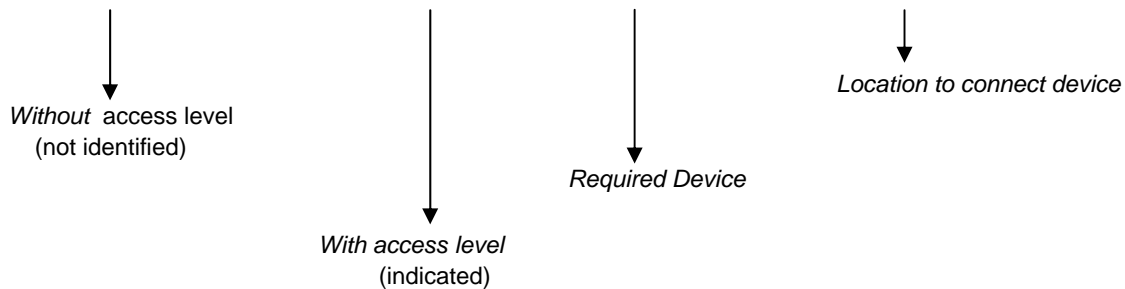

02.10.03 - Evacuation of disabled persons using lifts (EN81-76).....	4
02.10.03.01 - EN81-76 operation.....	4
02.10.03.02 - Main evacuation service floor.....	4
02.10.03.03 - Door to open at main evacuation service floor	4
02.10.03.10 - Input for evacuation lift switch	4
02.10.03.11 - input for return the car to the main evacuation service floor	4
02.10.03.12 - Input for evacuation service suspended	4
02.10.03.20 - Output to control the evacuation signal on floors	4
02.10.03.21 - Output to control the evacuation mode suspended signal on floors	5
02.10.03.30 - Output to control the evacuation signal on car	5
02.10.03.31 - Output to control the evacuation mode suspended signal on car.....	5
02.10.03.40 - Output to control the intercom power	5
ANNEXES AND EXAMPLES.....	6
ANNEX 1. INPUTS AND OUTPUTS AVAILABLE FOR HIDRA CRONO.....	6

MANUFACTURER'S NOTE:

Carlos Silva SA will accept no liability for claims concerning damage or costs derived from non-fulfilment of the indications of this manual, or giving a use beyond what is described here.

The information contained in this document may change without warning. Except for that allowed under the copyright laws, all reproduction, adaptation or translation is prohibited without written permission.

@Carlos Silva is a registered trademark of *Carlos Silva S.A.*

HIDRAsystem is a product owned by *Carlos Silva S.A.*

HIDRA CRONO is a product owned by *Carlos Silva S.A.*

02.10.03 - Evacuation of disabled persons using lifts (EN81-76)

Parameter setting on lifts for Evacuation of disabled persons using lifts

Basic - Intermediate - Advanced - Administrator - Keypad - PC - Controller - Car

02.10.03.01 - EN81-76 operation

Enables the EN81-76 operation

0 - Disabled

1 - Enabled

FACTORY DEFAULT: 0

Basic - Intermediate - Advanced - Administrator - Keypad - PC - Controller - Car

02.10.03.02 - Main evacuation service floor

Defines which floor is designed as the main evacuation service floor

FACTORY DEFAULT: 0

MIN: 0

MAX: 31

STEP: 1

Basic - Intermediate - Advanced - Administrator - Keypad - PC - Controller - Car

02.10.03.03 - Door to open at main evacuation service floor

Defines which door will be open on the main evacuation service floor

FACTORY DEFAULT: 1

Basic - Intermediate - Advanced - Administrator - Keypad - PC - Controller - Car

02.10.03.10 - Input for evacuation lift switch

Defines where is connected the evacuation service input switch.

This input is open during normal operation and closes in case of use under evacuation mode

FACTORY DEFAULT: NoUSE

Basic - Intermediate - Advanced - Administrator - Keypad - PC - Controller - Car

02.10.03.11 - input for return the car to the main evacuation service floor

Defines where is connected the signal to return the car to the main evacuation service floor.

This input is open during normal operation and closes to return the car to the main evacuation service floor

FACTORY DEFAULT: NoUSE

Basic - Intermediate - Advanced - Administrator - Keypad - PC - Controller - Car

02.10.03.12 - Input for evacuation service suspended

Defines where is connected the signal to suspend the evacuation service.

This input is open during normal operation and closes to suspend the evacuation service

FACTORY DEFAULT: NoUSE

Basic - Intermediate - Advanced - Administrator - Keypad - PC - Controller - Car

02.10.03.20 - Output to control the evacuation signal on floors

Defines the output to control the floor signalling of lift under evacuation service

FACTORY DEFAULT: NoUSE

Basic - Intermediate - Advanced - Administrator - Keypad - PC - Controller - Car

02.10.03.21 - Output to control the evacuation mode suspended signal on floors

Defines the output to control the floor signalling of lift with evacuation mode suspended

FACTORY DEFAULT: NoUSE

Basic - Intermediate - Advanced - Administrator - Keypad - PC - Controller - Car

02.10.03.30 - Output to control the evacuation signal on car

Defines the output to control the car signalling of lift under evacuation service

FACTORY DEFAULT: NoUSE

Basic - Intermediate - Advanced - Administrator - Keypad - PC - Controller - Car

02.10.03.31 - Output to control the evacuation mode suspended signal on car

Defines the output to control the car signalling of lift with evacuation mode suspended

FACTORY DEFAULT: NoUSE

Basic - Intermediate - Advanced - Administrator - Keypad - PC - Controller - Car

02.10.03.40 - Output to control the intercom power

Defines which output will be used to control the intercom supply

FACTORY DEFAULT: NoUSE

Basic - Intermediate - Advanced - Administrator - Keypad - PC - Controller - Car

Annexes and Examples

Annex 1. Inputs and outputs available for Hidra Crono

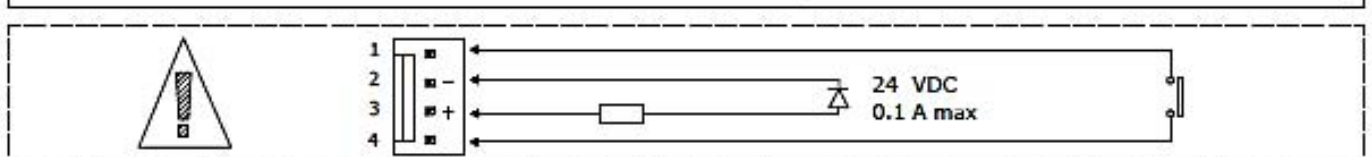
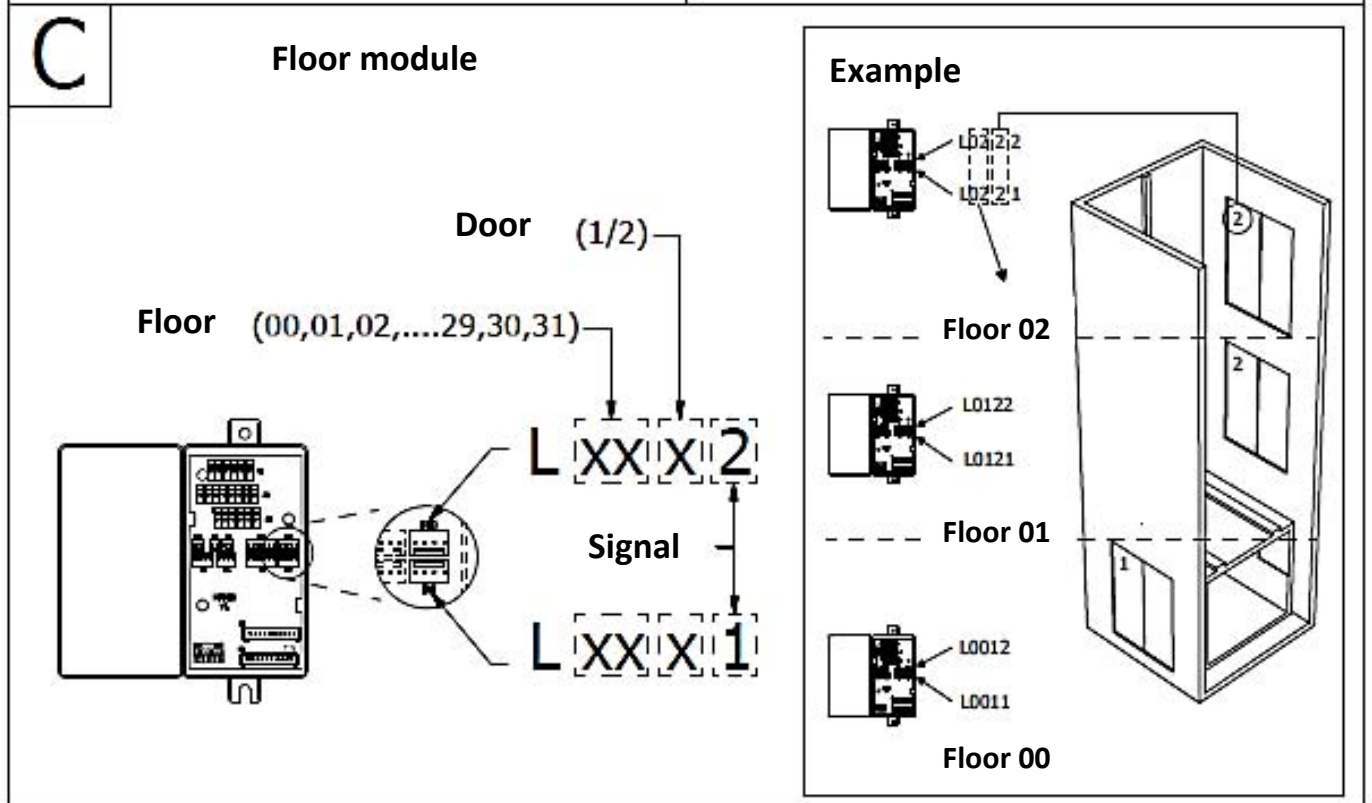
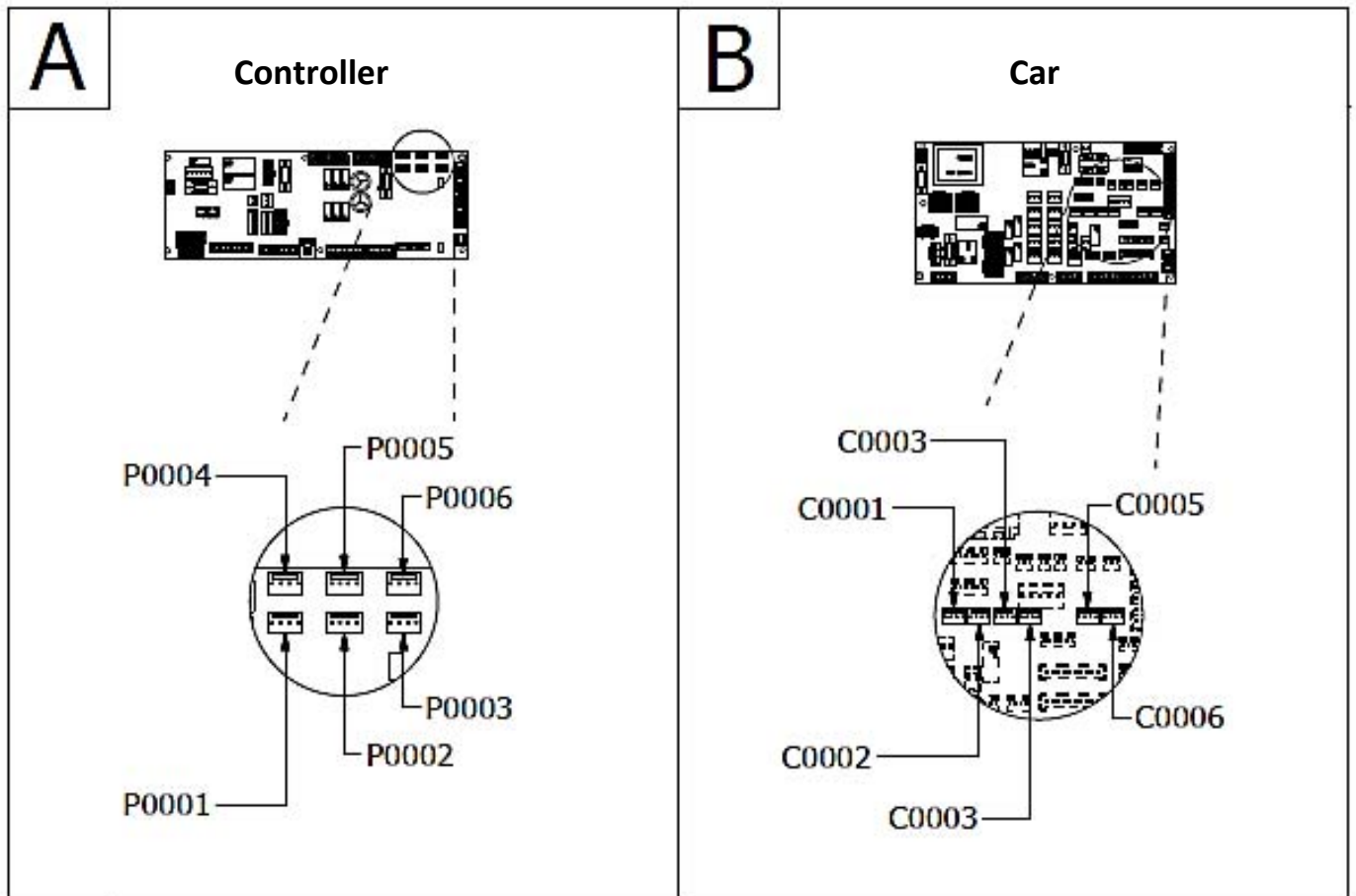

Example of menú settings

-If it is required to connect a fire signal in the FLOOR 01

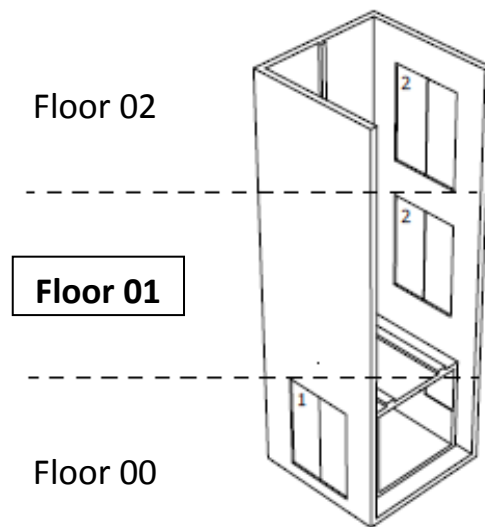

-It will be wired to the FLOOR 01 MP module that serves that door, **and it can be wired in any of the two possible inputs**

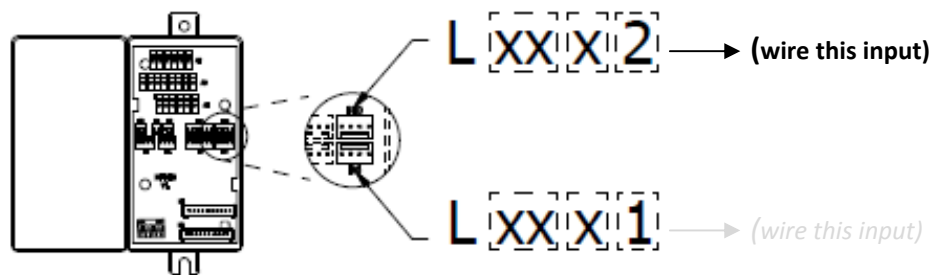

-Configure the setup menu to adjust the lift controller

02.10.01.04 – Main alarm signal

Defines where the main alarm signal EN81-73is connected

Set...

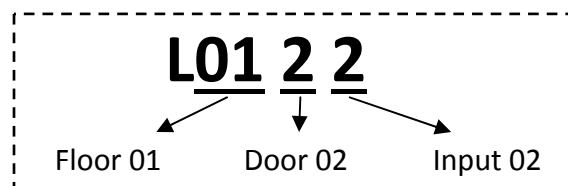



www.carlos-silva.com



Carlos Silva

Soluciones y Sistemas Electrónicos para Control de Ascensores
Electronic Lift Control Solutions & Systems
Lösungen und Elektronische Systeme zur Aufzugsteuerung Solutions et
Systèmes Électroniques pour Contrôle des Ascenseurs

Salvador Albert i Riera 3, 08339 Vilassar de Dalt, Barcelona, ESPAÑA
GPS: (41° 30' 51" N. / 2° 22' 12" E.)
Tel. +34 937 541 980 Fax +34 937 541 983
www.carlos-silva.com
e-mail: info@carlos-silva.com

Servicio Post-Venta (After-Sales Department) Tel: +34 937 541 981
e-mail: postventa@carlos-silva.com

DC81215Q00



15

EN81-76

ENG