

HIDRA CRONO Controller

EN81-72 / AS1735.1-2003 Programming Manual



DC81210Q00



ENGLISH

How to use the manual

Each parameter is described as follows:

XX.XX.XX - Parameter name

Parameter description (*The description may include allowable values and notes*)

EXAMPLE: *Represents a possible situation*

FACTORY DEFAULT: *Default parameters*

MIN: *Minimum value (X)*

MAX: *Maximum value (XX)*

STEP: *Increase (X)*

Access Level
(Level required to view or change the parameter)

Device
(Device required to view or change the parameter)

Connection Location
(Location to connect device)

Example

02.02.01.03 - Close door attempts

Sets the number of door close attempts before entering blocked door mode

FACTORY DEFAULT: 10

MIN: 10

MAX: 20

STEP: 1

Basic - Intermediate - Advanced - Administrator - Keypad - PC -

Controller - Car

↓
Without access level
(not identified)

↓
With access level
(indicated)

↓
Required Device

↓
Location to connect device

02.10.02 - Fire fighting lift (EN81-72 / AS 1735.1-2003)	4
02.10.02.01 - EN81-72 / AS 1735.1-2003 enable	4
02.10.02.10 - Fire service access level	4
02.10.02.11 - Door to open at fire service access level	4
02.10.02.20 - Firefighters lift switch input	4
02.10.02.21 - Additional external input for automatically return to fire service access level	4
02.10.02.22 - Additional firefighters car key switch input	4
02.10.02.30 - Output to control the well, machine room lighting and fire service communication system	4
02.10.02.40 - Output signal for close door 1 under reduced power	5
02.10.02.41 - Door 1 fully open signal	5
02.10.02.50 - Output signal for close door 2 under reduced power	5
02.10.02.51 - Door 2 fully open signal	5
02.10.02.80 - Multiple car calls allowed during phase 2	5
02.10.02.81 - Close doors automatically during phase 2	5
ANNEXES AND EXAMPLES.....	6
ANNEX 1. INPUTS AND OUTPUTS AVAILABLE FOR HIDRA CRONO.....	6

MANUFACTURER'S NOTE:

Carlos Silva SA will accept no liability for claims concerning damage or costs derived from non-fulfilment of the indications of this manual, or giving a use beyond what is described here.

The information contained in this document may change without warning. Except for that allowed under the copyright laws, all reproduction, adaptation or translation is prohibited without written permission.

@Carlos Silva is a registered trademark of *Carlos Silva S.A.*
HIDRAsystem is a product owned by *Carlos Silva S.A.*
HIDRA CRONO is a product owned by *Carlos Silva S.A.*

02.10.02 - Fire fighting lift (EN81-72 / AS 1735.1-2003)

Set of parameter related with lifts which could be used by firefighters in case of fire

Basic - Intermediate - Advanced - Administrator - Keypad - PC - Controller - Car

02.10.02.01 - EN81-72 / AS 1735.1-2003 enable

EN81-72 / AS 1735.1-2003 enable

FACTORY DEFAULT: 0

Basic - Intermediate - Advanced - Administrator - Keypad - PC - Controller - Car

02.10.02.10 - Fire service access level

Sets the fire service access level where the car is parked on phase 1

FACTORY DEFAULT: 0

MIN: 0

MAX: 31

STEP: 1

Basic - Intermediate - Advanced - Administrator - Keypad - PC - Controller - Car

02.10.02.11 - Door to open at fire service access level

Sets the door to open at fire service access level in case of fire

FACTORY DEFAULT: 1

Basic - Intermediate - Advanced - Administrator - Keypad - PC - Controller - Car

02.10.02.20 - Firefighters lift switch input

Defines where is connected the Firefighters lift switch input. This input must be closed during normal operation and will be opened in case of firefighters operation

FACTORY DEFAULT: NoUSE

Basic - Intermediate - Advanced - Administrator - Keypad - PC - Controller - Car

02.10.02.21 - Additional external input for automatically return to fire service access level

Defines where is connected the Additional external input for automatically recall to fire service access level. This input must be closed during normal operation and will be opened when the recall operation is needed.

NOTE: If this function is not required, sets to NoUSE

FACTORY DEFAULT: NoUSE

Basic - Intermediate - Advanced - Administrator - Keypad - PC - Controller - Car

02.10.02.22 - Additional firefighters car key switch input

Defines where is connected the Additional firefighters car key switch input. This input must be opened during normal operation and will be closed on phase 2 (firefighters operation)

NOTE: If is not necessary this function, sets to NoUSE

FACTORY DEFAULT: NoUSE

Basic - Intermediate - Advanced - Administrator - Keypad - PC - Controller - Car

02.10.02.30 - Output to control the well, machine room lighting and fire service communication system

Defines where is the output to control the well, machine room lighting and fire service communication system

FACTORY DEFAULT: NoUSE

Basic - Intermediate - Advanced - Administrator - Keypad - PC - Controller - Car

02.10.02.40 - Output signal for close door 1 under reduced power

Defines where is located the output signal for close door 1 under reduced power

FACTORY DEFAULT: NoUSE

Basic - Intermediate - Advanced - Administrator - Keypad - PC - Controller - Car

02.10.02.41 - Door 1 fully open signal

Defines where is connected the signal of door 1 fully opened. This input must be closed when door 1 is fully opened

FACTORY DEFAULT: NoUSE

Basic - Intermediate - Advanced - Administrator - Keypad - PC - Controller - Car

02.10.02.50 - Output signal for close door 2 under reduced power

Defines where is located the output signal for close door 2 under reduced power

FACTORY DEFAULT: NoUSE

Basic - Intermediate - Advanced - Administrator - Keypad - PC - Controller - Car

02.10.02.51 - Door 2 fully open signal

Defines where is connected the signal of door 2 fully opened. This input must be closed when door 2 is fully opened

FACTORY DEFAULT: NoUSE

Basic - Intermediate - Advanced - Administrator - Keypad - PC - Controller - Car

02.10.02.80 - Multiple car calls allowed during phase 2

During phase 2 of firefighters operation, allows to make more than one car call at a time or not. If EN81-72 is required, this parameter must be 0, if AS 1735.1-2003 is required, this parameter must be 1

0 - EN81-72

1 - AS 1735.1-2003

FACTORY DEFAULT: 0

Basic - Intermediate - Advanced - Administrator - Keypad - PC - Controller - Car

02.10.02.81 - Close doors automatically during phase 2

During phase 2 of firefighters operation, if a car call is made the lift will close door automatically or will be initiated by constant pressure on door close button.

0 - The door closing will be initiated by constant pressure on door close button (required on AS 1735.1-2003)

1 - The door closing will be initiated by a new car call (required on EN81-72)

FACTORY DEFAULT: 1

Basic - Intermediate - Advanced - Administrator - Keypad - PC - Controller - Car

Annexes and Examples

Annex 1. Inputs and outputs available for Hidra Crono

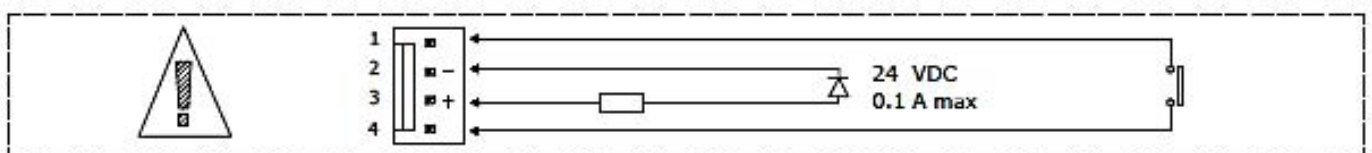
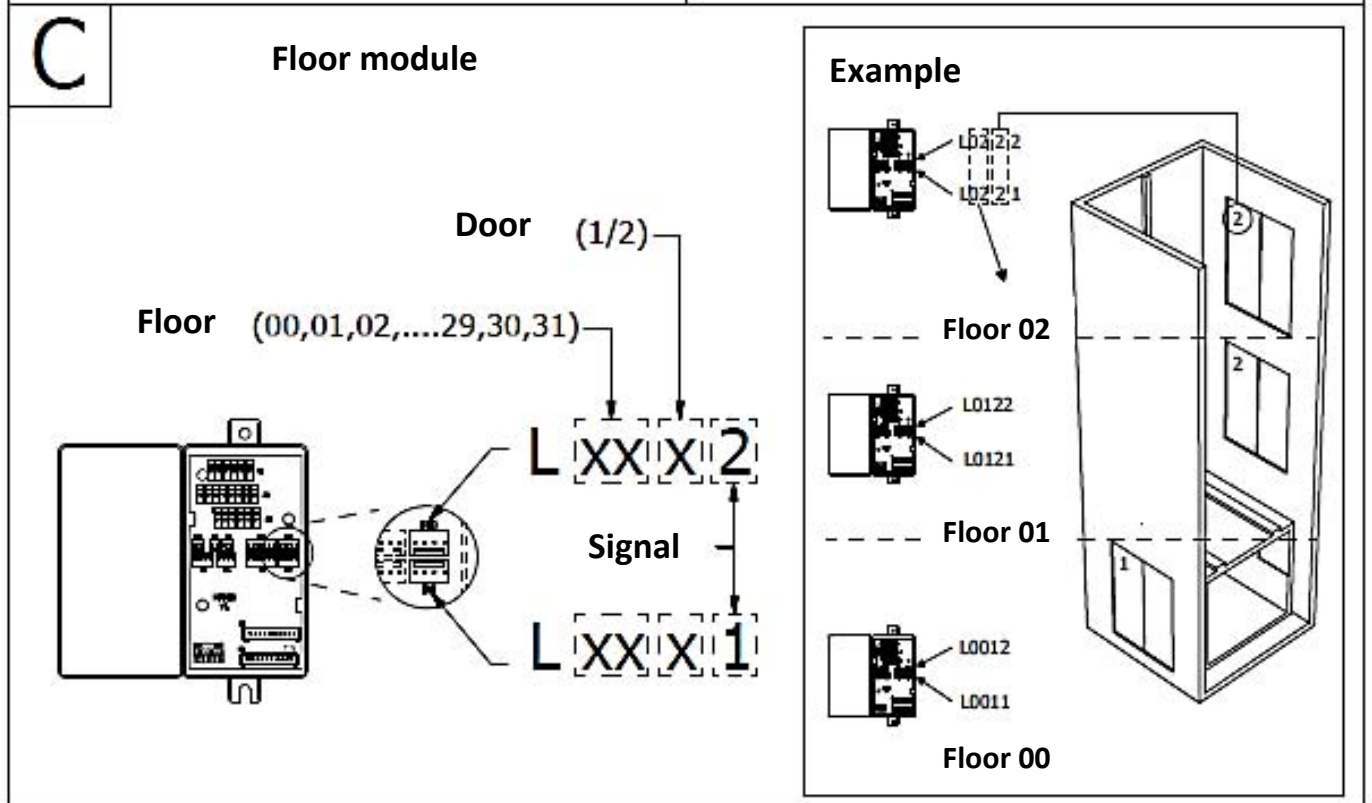
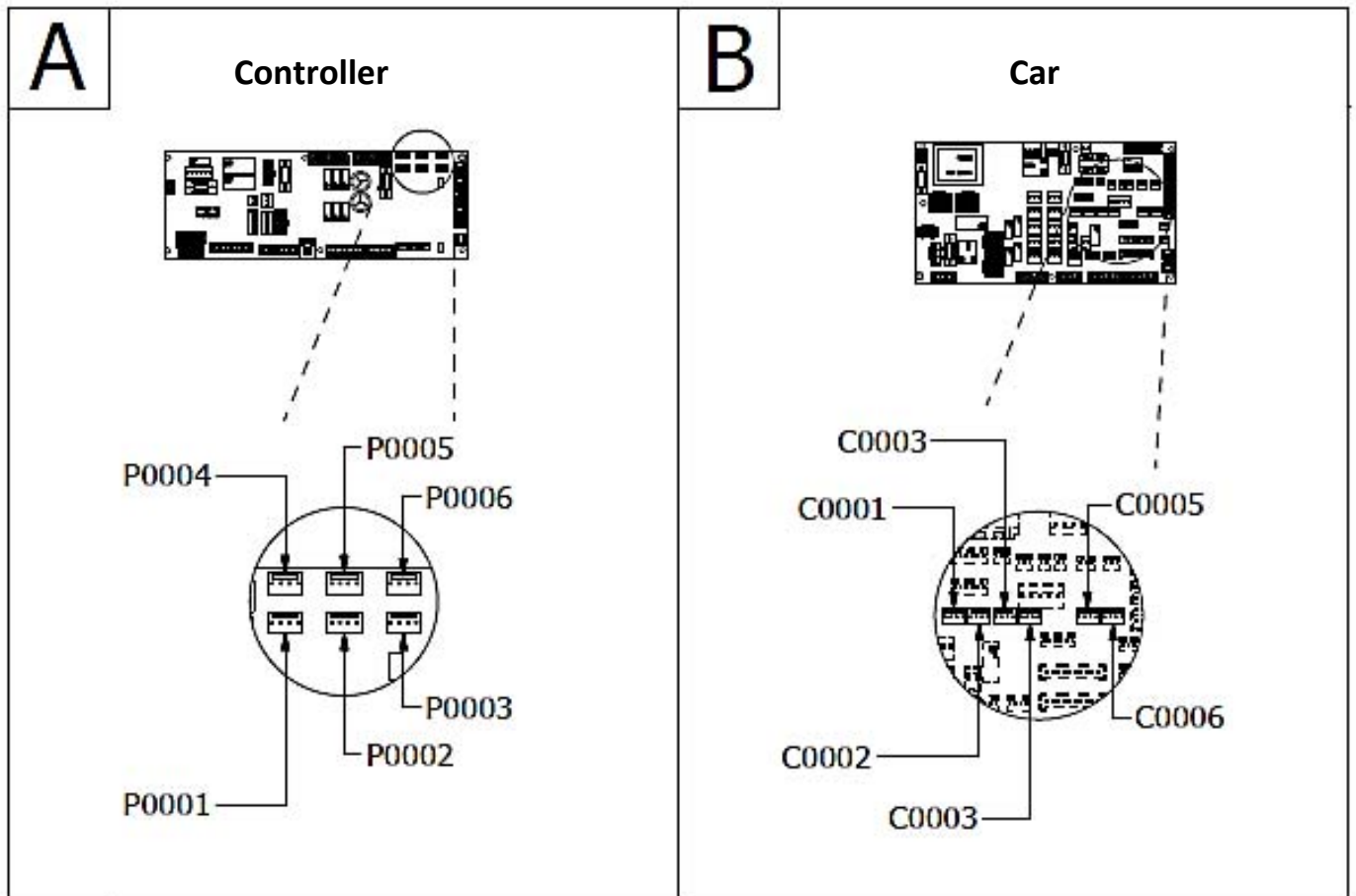

Example of menu settings

-If it is required to connect a fire signal in the FLOOR 01

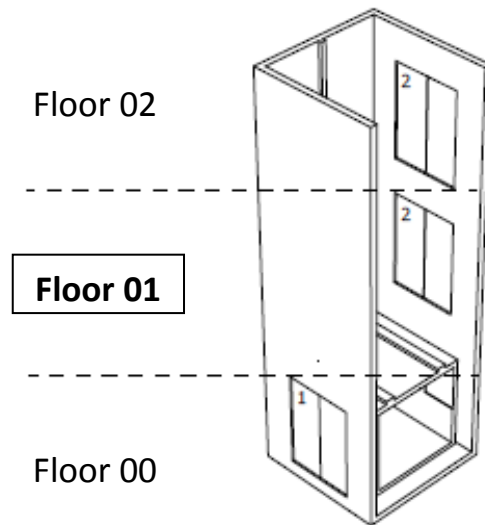

-It will be wired to the FLOOR 01 MP module that serves that door, **and it can be wired in any of the two possible inputs**

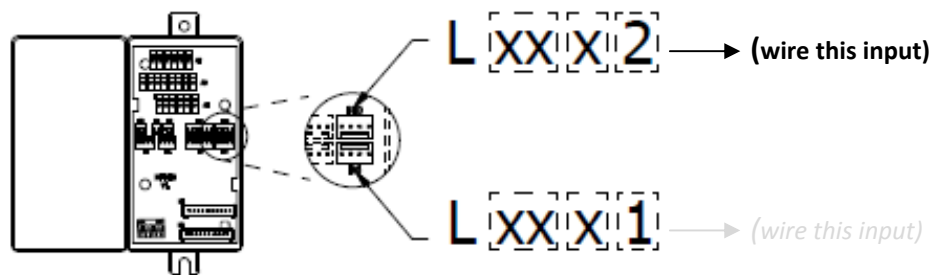

-Configure the setup menu to adjust the lift controller

02.10.01.04 – Main alarm signal

Defines where the main alarm signal EN81-73is connected

Set...

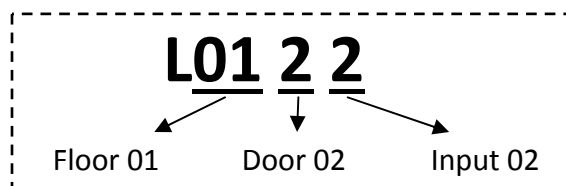



www.carlos-silva.com



Carlos Silva

Soluciones y Sistemas Electrónicos para Control de Ascensores
Electronic Lift Control Solutions & Systems
Lösungen und Elektronische Systeme zur Aufzugsteuerung Solutions et
Systèmes Électroniques pour Contrôle des Ascenseurs

Salvador Albert i Riera 3, 08339 Vilassar de Dalt, Barcelona, ESPAÑA

GPS: (41° 30' 51" N. / 2° 22' 12" E.)

Tel. +34 937 541 980 Fax +34 937 541 983

www.carlos-silva.com

e-mail: info@carlos-silva.com

Servicio Post-Venta (After-Sales Department) Tel: +34 937 541 981

e-mail: postventa@carlos-silva.com

DC81210Q00



10

EN81-72

ENG